

*THE TRUE COLOR OF **HOCKEY***<sup>™</sup>

*WE ARE **BLUE SPORTS**<sup>™</sup>*

*WE PROVIDE HIGH QUALITY HOCKEY  
ACCESSORIES, ACCESSIBLE TO ALL.*

*THROUGH QUALITY HUMAN SERVICE AND  
AVAILABILITY, WE FUEL THE PASSION OF HOCKEY  
FROM GENERATION TO GENERATION.*

*WE ARE THE TRUE COLOR OF **HOCKEY**<sup>™</sup>*



## CONTACT US

### CUSTOMER SUPPORT

Jacob Carroll  
jacob@blue-sports.com

### MARKETING

Matthieu Derome  
matthieu@blue-sports.com

### ADMINISTRATION

Anny Côté  
administration@blue-sports.com

## FOLLOW US

**INSTAGRAM**  
@BLUESPORTSOFFICIAL

**FACEBOOK**  
@BLUESPORTSHOCKEY



**BEST SELLER**



**CUSTOMIZABLE**

- HOCKEY TAPE** ..... 4-5
- HOCKEY LACES** ..... 6-9
- SKATE GUARDS** ..... 10-13
- HOCKEY SOCKS** ..... 14-15
- BASE LAYERS** ..... 16-17
- COACH & REFEREE** ..... 18-21
- TRAINING** ..... 22-24
- PUCKS & BALLS** ..... 25-26
- ACCESSORIES** ..... 27-32
- SHARPENING & REPAIRS** ..... 33-34

1000NG

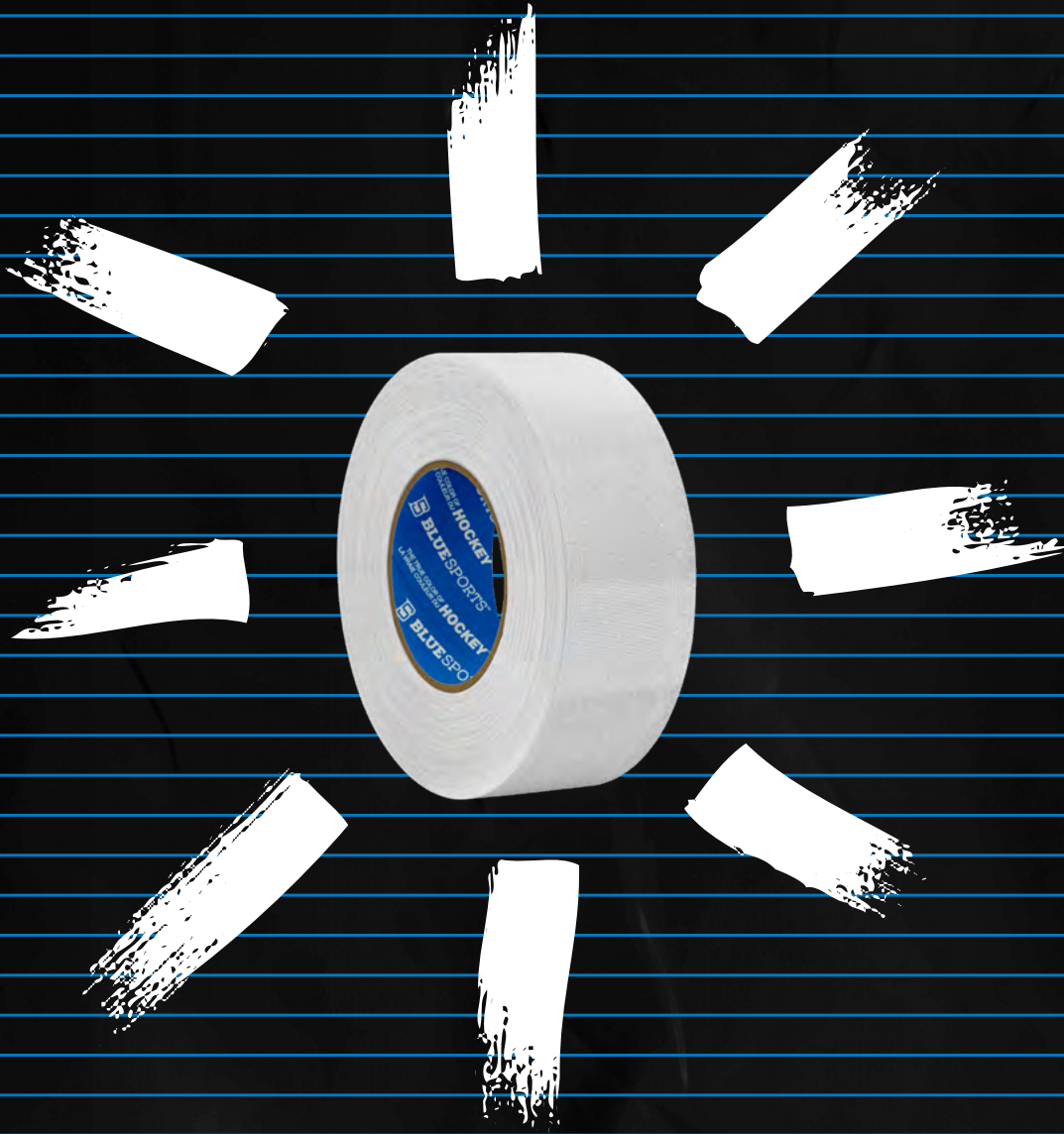

LASTING

**POWERFLEX GRIP TAPE**

- Flexible tape bonds to itself
- Easy-tear without scissors



**3815** - 1.5" x 5 yds / (38mm x 4,57m) 1/48

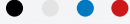

**HOCKEY GRIP TAPE**

- Optimized feel & control
- Reduce vibration



- 906000-BK** - Black
- 906001-WH** - White
- 906002-BL** - Blue
- 906003-OR** - Orange
- 906004-NEON** - Neon Green
- 906005-YE** - Yellow
- 906010-BLK-C** - Black camo
- 906011-RBW-C** - Red camo

**GREAT FOR PRO-SHOP!**



**ONE(1)-SIDED DISPLAY**

- Shin pad tape (36x)
- Cloth tape - White (60x)
- Cloth tape - Black (60x)
- Laces† (90x)
- Socks - Pro-Skin‡ (36x)
- Soakers - Platinum (18x)
- Skate Guards - Premium Walkable (24x)

**INCLUDES  
324  
PRODUCTS**

**BL-DISPLAY-1** - 324 products + Display & header card

**TWO(2)-SIDED DISPLAY**

- Shin pad tape (72x)
- Cloth tape - White (120x)
- Cloth tape - Black (120x)
- Laces† (180x)
- Socks (Pro-Skin)‡ (72x)
- Soakers (Platinum)° (36x)
- Skate Guards (Premium Walkable)Δ (48x)

**INCLUDES  
648  
PRODUCTS**

**BL-DISPLAY-2** - 648 products + Display & header card

† Choice of Titanium or XL-Pro - up to 6 sizes & colors  
‡ Up to 6 sizes & colors  
° Up to 3 colors  
Δ Up to 4 colors

# LACES



# FOR ALL

# FROM NON-WAXED TO HEAVY-WAXED

**BLUE SPORTS™ laces for all skates and sizes. Some players prefer waxed hockey laces because of their ability to grip tighter or stay looser without coming undone.**

**While waxed laces are better in certain circumstances, there are disadvantages, too. Unwaxed laces are easier to grasp and untie, which is especially helpful to young players.**



## TITANIUM - WAXED / MOLDED-TIP

- 902040 - White/Black - 72" (183cm)
- 902041 - White/Black - 84" (213cm)
- 902042 - White/Black - 96" (244cm)
- 902043 - White/Black - 108" (274cm)
- 902044 - White/Black - 120" (305cm)
- 902045 - White/Black - 130" (330cm)

- 902046 - Black/White - 72" (183cm)
- 902047 - Black/White - 84" (213cm)
- 902048 - Black/White - 96" (244cm)
- 902049 - Black/White - 108" (274cm)
- 902050 - Black/White - 120" (305cm)
- 902051 - Black/White - 130" (330cm)

- 902052 - Red/Black - 72" (183cm)
- 902053 - Red/Black - 84" (213cm)
- 902054 - Red/Black - 96" (244cm)
- 902055 - Red/Black - 108" (274cm)
- 902056 - Red/Black - 120" (305cm)

- 902058 - Yellow/Black - 72" (183cm)
- 902059 - Yellow/Black - 84" (213cm)
- 902060 - Yellow/Black - 96" (244cm)
- 902061 - Yellow/Black - 108" (274cm)
- 902062 - Yellow/Black - 120" (305cm)

- 902064 - Royal/White - 72" (183cm)
- 902065 - Royal/White - 84" (213cm)
- 902066 - Royal/White - 96" (244cm)
- 902067 - Royal/White - 108" (274cm)
- 902068 - Royal/White - 120" (305cm)

- 902070 - Orange/Black - 72" (183cm)
- 902071 - Orange/Black - 84" (213cm)
- 902072 - Orange/Black - 96" (244cm)
- 902073 - Orange/Black - 108" (274cm)
- 902074 - Orange/Black - 120" (305cm)

- 902076 - Black/Grey/White - 72" (183cm)
- 902077 - Black/Grey/White - 84" (213cm)
- 902078 - Black/Grey/White - 96" (244cm)
- 902079 - Black/Grey/White - 108" (274cm)
- 902080 - Black/Grey/White - 120" (305cm)

- 902082 - Purple/White - 72" (183cm)
- 902083 - Purple/White - 84" (213cm)
- 902084 - Purple/White - 96" (244cm)
- 902085 - Purple/White - 108" (274cm)
- 902086 - Purple/White - 120" (305cm)

- 902088 - Lime/Green/Black - 72" (183cm)
- 902089 - Lime/Green/Black - 84" (213cm)
- 902090 - Lime/Green/Black - 96" (244cm)
- 902091 - Lime/Green/Black - 108" (274cm)
- 902092 - Lime/Green/Black - 120" (305cm)

- 902094 - Neon Pink/Black - 72" (183cm)
- 902095 - Neon Pink/Black - 84" (213cm)
- 902096 - Neon Pink/Black - 96" (244cm)
- 902097 - Neon Pink/Black - 108" (274cm)
- 902098 - Neon Pink/Black - 120" (305cm)

- 902101 - Columbia/Black - 72" (183cm)
- 902102 - Columbia/Black - 84" (213cm)
- 902103 - Columbia/Black - 96" (244cm)
- 902104 - Columbia/Black - 108" (274cm)
- 902105 - Columbia/Black - 120" (305cm)

- 902114 - Silver/Black - 72" (183cm)
- 902115 - Silver/Black - 84" (213cm)
- 902116 - Silver/Black - 96" (244cm)
- 902117 - Silver/Black - 108" (274cm)
- 902118 - Silver/Black - 120" (305cm)

## TITANIUM - BULK / BANDED

- PB-902040 - White/Black - 72" (183cm)
- PB-902041 - White/Black - 84" (213cm)
- PB-902042 - White/Black - 96" (244cm)
- PB-902043 - White/Black - 108" (274cm)
- PB-902044 - White/Black - 120" (305cm)





**XL-PRO - NON-WAXED / WIDER LACE / MOLDED-TIP**

- 901961 - White/Black - 72" (183cm)
- 901962 - White/Black - 84" (213cm)
- 901963 - White/Black - 96" (244cm)
- 901964 - White/Black - 108" (274cm)
- 901965 - White/Black - 120" (305cm)
- 901966 - White/Black - 130" (330cm)

- 902912 - Royal/White - 72" (183cm)
- 902913 - Royal/White - 84" (213cm)
- 902914 - Royal/White - 96" (244cm)
- 902915 - Royal/White - 108" (274cm)
- 902916 - Royal/White - 120" (305cm)

- 902936 - Columbia/Black - 72" (183cm)
- 902937 - Columbia/Black - 84" (213cm)
- 902938 - Columbia/Black - 96" (244cm)
- 902939 - Columbia/Black - 108" (274cm)
- 902940 - Columbia/Black - 120" (305cm)

- 901967 - Black/White - 72" (183cm)
- 901968 - Black/White - 84" (213cm)
- 901969 - Black/White - 96" (244cm)
- 901970 - Black/White - 108" (274cm)
- 901971 - Black/White - 120" (305cm)
- 901972 - Black/White - 130" (330cm)

- 902918 - Lime/Green/Black - 72" (183cm)
- 902919 - Lime/Green/Black - 84" (213cm)
- 902920 - Lime/Green/Black - 96" (244cm)
- 902921 - Lime/Green/Black - 108" (274cm)
- 902922 - Lime/Green/Black - 120" (305cm)

- 902942 - Silver/Black - 72" (183cm)
- 902943 - Silver/Black - 84" (213cm)
- 902944 - Silver/Black - 96" (244cm)
- 902945 - Silver/Black - 108" (274cm)
- 902946 - Silver/Black - 120" (305cm)

- 902900 - Red/Black - 72" (183cm)
- 902901 - Red/Black - 84" (213cm)
- 902902 - Red/Black - 96" (244cm)
- 902903 - Red/Black - 108" (274cm)
- 902904 - Red/Black - 120" (305cm)

- 902924 - Orange/Black - 72" (183cm)
- 902925 - Orange/Black - 84" (213cm)
- 902926 - Orange/Black - 96" (244cm)
- 902927 - Orange/Black - 108" (274cm)
- 902928 - Orange/Black - 120" (305cm)

- 902948 - Forest Green/Black - 72" (183cm)
- 902949 - Forest Green/Black - 84" (213cm)
- 902950 - Forest Green/Black - 96" (244cm)
- 902951 - Forest Green/Black - 108" (274cm)
- 902952 - Forest Green/Black - 120" (305cm)

- 902906 - Yellow/Black - 72" (183cm)
- 902907 - Yellow/Black - 84" (213cm)
- 902908 - Yellow/Black - 96" (244cm)
- 902909 - Yellow/Black - 108" (274cm)
- 902910 - Yellow/Black - 120" (305cm)

- 902930 - Neon Pink/Black - 72" (183cm)
- 902931 - Neon Pink/Black - 84" (213cm)
- 902932 - Neon Pink/Black - 96" (244cm)
- 902933 - Neon Pink/Black - 108" (274cm)
- 902934 - Neon Pink/Black - 120" (305cm)

**XL-PRO - BULK / BANDED**

- PB-901961 - White/Black - 72" (183cm)
- PB-901962 - White/Black - 84" (213cm)
- PB-901963 - White/Black - 96" (244cm)
- PB-901964 - White/Black - 108" (274cm)
- PB-901965 - White/Black - 120" (305cm)



SKATE SIZE
YOUTH 8 - JUNIOR 3
JUNIOR 3.5 - 5.5
ADULT 5.5 - 7
ADULT 7 - 9
ADULT 9 - 11
ADULT 11 - 13



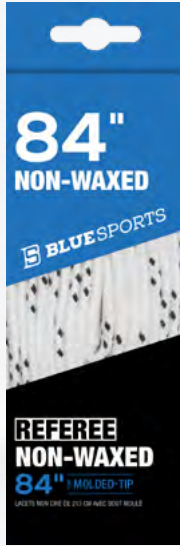

**REFEREE - NON-WAXED / MOLDED-TIP**

- 901990 - White - 84" (213cm)
- 901991 - White - 96" (244cm)
- 901992 - White - 108" (274cm)
- 901993 - White - 120" (305cm)



**REFEREE - WAXED / MOLDED-TIP**

- 901995 - White - 84" (213cm)
- 901996 - White - 96" (244cm)
- 901997 - White - 108" (274cm)
- 901998 - White - 120" (305cm)



**CLASSIC - FIGURE SKATE / REGULAR-TIP**

- |                               |                               |
|-------------------------------|-------------------------------|
| 903500 - White - 63" (160cm)  | 903515 - Camel - 74" (188cm)  |
| 903501 - White - 74" (188cm)  | 903516 - Camel - 84" (213cm)  |
| 903502 - White - 84" (213cm)  | 903517 - Camel - 98" (249cm)  |
| 903503 - White - 98" (249cm)  | 903518 - Camel - 110" (279cm) |
| 903504 - White - 110" (279cm) | 903519 - Camel - 120" (305cm) |
| 903505 - White - 120" (305cm) |                               |

LENGHT	
→	72" - 183 CM
→	84" - 213 CM
→	96" - 244 CM
→	108" - 274 CM
→	120" - 305 CM
→	130" - 330 CM

BUILT LIKE



A SHOE

# WALKABLE

In 2015, we decided to develop a skate guard that could be walked with. The goal was to create a product with shoe-like properties. The first technical drawing of the prototype was produced in March that year. Several prototypes were developed and tested until the launch in 2016.

Produced in a shoe manufacturing plant, the PREMIUM SKATE GUARD is based on our PLATINUM SOAKER, we've added a wide cut-resistant band to the absorbent lining and an outsole made of 100% EVA made it slip-resistant.

Today we're in the 4th generation of the products, and this is now a category in the market.



INSOLE DESIGNED TO  
TO WALK WITH YOUR SKATES



## PREMIUM WALKABLE SKATE GUARDS - ANTI-SKID



- 3" wide nylon webbing on the bottom of the insole
- Outsole design to walk & reduce slipping
- Water absorbing lining



### Youth (6-10)

NGTREK-YSM-BLK - Black ●

### Youth (11-13,5)

NGTREK-YLXL-BLK - Black ●

NGTREK-YLXL-RED - Red ●

NGTREK-YLXL-ROY - Royal Blue ●

NGTREK-YLXL-SIL - Silver ●

NGTREK-YLXL-YEL - Yellow ●

### Junior (1-5)

NGTREK-J-BLK - Black ●

NGTREK-J-RED - Red ●

NGTREK-J-ROY - Royal Blue ●

NGTREK-J-SIL - Silver ●

NGTREK-J-YEL - Yellow ●

### Senior (6-8,5)

NGTREK-S-BLK - Black ●

NGTREK-S-RED - Red ●

NGTREK-S-ROY - Royal Blue ●

NGTREK-S-SIL - Silver ●

NGTREK-S-YEL - Yellow ●

### Senior XL (9-12)

NGTREK-SXL-BLK - Black ●

NGTREK-SXL-RED - Red ●

NGTREK-SXL-ROY - Royal Blue ●

NGTREK-SXL-SIL - Silver ●

NGTREK-SXL-YEL - Yellow ●

**SOAKERS - PRO-DRY**



- Ultra thick terry cloth lining
- Interior & exterior blade protection strips
- Moisture wicking material

**Youth (4-13)**

904000 - Black	●
904004 - Blue	●
904008 - Red	●
904012 - Yellow	●

**Junior (1-5)**

904001 - Black	●
904005 - Blue	●
904009 - Red	●
904013 - Yellow	●

**Senior (6-12)**

904002 - Black	●
904006 - Blue	●
904010 - Red	●
904014 - Yellow	●



PLAYER NUMBER GOES HERE

**SOAKERS - PLATINUM**



- Protect your blades
- Terry cloth interior that absorbs excess water
- Made of water resistant polyester material

**Youth (4-13)**

903569 - Black	●
903572 - Silver	●
903575 - Blue	●
903578 - Red	●
903581 - Yellow	●
903602 - Forest Green	●
903590 - Midnight Blue	●
903593 - Orange	●
903596 - Pink	●
903599 - Purple	●

**Junior (1-5)**

903570 - Black	●
903573 - Silver	●
903576 - Blue	●
903579 - Red	●
903582 - Yellow	●
903585 - Forest Green	●
903588 - Maroon	●
903591 - Midnight Blue	●
903594 - Orange	●
903597 - Pink	●
903600 - Purple	●

**Senior (6-12)**

903571 - Black	●
903574 - Silver	●
903577 - Blue	●
903580 - Red	●
903583 - Yellow	●
903586 - Forest Green	●
903589 - Maroon	●
903592 - Midnight Blue	●
903595 - Orange	●
903598 - Pink	●
903601 - Purple	●



**SOAKERS - TERRY CLOTH**

- For hockey or figure skates
- Keeps your blades dry and protected
- Terry cloth lining to help prevent rust

**Youth (4-13)**

B-7295 - Black	●
B-7296 - Red	●
B-7297 - Blue	●
B-7298 - Silver	●

**Junior (1-5)**

B-7300 - Black	●
B-7301 - Red	●
B-7302 - Blue	●
B-7303 - Silver	●

**Senior (6-12)**

B-7306 - Black	●
B-7307 - Red	●
B-7308 - Blue	●
B-7309 - Silver	●



**SKATE GUARDS - PLASTIC**



- One size fits all  
- Designed for hockey skates, suitable for figure skates

**NP214**

Black	●	Pink	●
White	○	Forest Green	●
Silver	●	Midnight Blue	●
Red	●	Electric Blue	●
Yellow	●	Purple	●



**SKATE GUARDS - CLASSIC FIGURE SKATE**

- One size fits all  
- Designed for figure skates

**NP217 - Clear**

Pink	●	Lemon	●
Purple	●	Raspberry	●
Peach	●	Lime	●
Blue	●	Electric Blue	●

**NP216 - Opaque**

White	○
Purple	●
Pink	●
Red	●



**SKATE GUARDS - QUICK-STEP**

- One size fits all  
- Designed for hockey skates

<b>B-SI01</b> - Black	●
<b>B-SI02</b> - White	○
<b>B-SI03</b> - Blue	●
<b>B-SPART-RED</b> - Red	●



**SKATE GUARDS - FIGURE**

Two(2) pieces  
- One size fits all

**NP225**

Black	●
White	○
Lemon	●
Lime	●
Grape	●
Red	●
Clear Peach	●
Ice Blue	●
Ice Pink	●
Pearl Silver	●
Electric Blue	●
Midnight Blue	●



# ULTIMATE



# COMFORT

# MATCHED TO YOUR FAVORITE TEAM COLORS

Our Pro-Skin Hockey Socks was designed to provide ultimate comfort. The Coolmax® fabric is breathable and the flat toe seam help prevent irritation caused by friction. They're so comfortable that you'll probably wear them even when you're not playing hockey.

## PRO-SKIN SOCKS



- Ultimate comfort
- Anti-friction toe seam
- Design using COOLMAX® fabric for maximal moisture management
- 86% Polyester, 10% COOLMAX®, 4% LYCRA®
- Pre-packed: 6 units

YOU'LL WEAR THEM EVEN WHEN YOU'RE NOT PLAYING



### Junior (1-5)

900251 - Black	●
900253 - Red	●
900254 - Orange	●
900255 - Yellow	●
900256 - Navy	●
900258 - Neon Green	●
900259 - Neon Pink	●
900260 - Royal Blue	●
900261 - Purple	●
900262 - White	○

### Senior (5-12)

900141 - Black	●
900143 - Red	●
900144 - Orange	●
900145 - Yellow	●
900146 - Navy	●
900148 - Neon Green	●
900149 - Neon Pink	●
900150 - Royal Blue	●
900151 - Purple	●
900152 - White	○

## PRO-SHIELD - CUT RESISTANT

- Made with 4-way stretch material comprising 3 compression zones promoting better blood flow
- 360 degree cut protection from ankle bone to over the calf
- 50% Cut resistant material, 35% Nylon, 5% Spandex, 10% Polyester
- High degree of cut resistance ASTM level 3 - EN 388

900351 - Senior Small (2-4)
900352 - Senior Medium (5-7)
900353 - Senior Large (8-10)
900354 - Senior X-Large (11-13)



## PRO-COMPRESSION - CUT RESISTANT



- Gradual compression
- Improves circulation and reduces muscle fatigue
- 75% Nylon, 20% Elastic, 5% Spandex
- Energizes legs

900400 - Small (2-4) - Blue	●
900401 - Medium (5-7) - Blue	●
900402 - Large (8-10) - Blue	●
900403 - X-Large (11-13) - Blue	●
900406 - Small (2-4) - Black	●
900407 - Medium (5-7) - Black	●
900404 - Large (8-10) - Black	●
900405 - X-Large (11-13) - Black	●



# HOCKEY



# FITTED



**ATHLETIC SUPPORT WITH CUP OR PELVIC PROTECTOR**

- Ergonomic cup
- 100 % polyester
- Fitted elastic straps



- B-7000** - Junior X-Small (16"-20")
- B-7001** - Junior Small (20"-24")
- B-7002** - Junior Medium (24"-28")
- B-7002-LARGE** - Junior Large (26"-30")
- B-7003** - Senior Small (26"-30")
- B-7004** - Senior Medium (30"-34")
- B-7005** - Senior Large (34"-38")
- B-7006** - Senior X-Large (38"-42")
- B-7006 XXL** - Senior XX-Large (42"-46")

- B-7100** - Junior X-Small (16"-20")
- B-7101** - Junior Small (20"-24")
- B-7102** - Junior Medium (24"-28")
- B-7103** - Senior Small (26"-30")
- B-7104** - Senior Medium (30"-34")
- B-7105** - Senior Large (34"-38")



**THREE(3) IN ONE(1) WITH CUP OR PELVIC PROTECTOR**

- Includes jock, cup, and sock fasteners
- Performance cup designed for comfort
- Robust fasteners and hooks

- B-7007-XS** - Junior X-Small (16"-20")
- B-7007** - Junior Small (20"-24")
- B-7008** - Junior Medium (24"-28")
- B-7008-L** - Junior Large (26"-30")
- B-7009** - Senior Small (26"-30")
- B-7010** - Senior Medium (30"-34")
- B-7011** - Senior Large (34"-38")
- B-7012** - Senior X-Large (38"-42")
- B-7012 XXL** - Senior XX-Large (42"-46")

- B-7013-XS** - Junior X-Small (16"-20")
- B-7013-S** - Junior Small (20"-24")
- B-7013** - Junior Medium (24"-28")
- B-7014** - Senior Small (26"-30")
- B-7015** - Senior Medium (30"-34")
- B-7016** - Senior Large (34"-38")



**GARTER BELT**

- Four independent heavy elastic drops
- Strong metal and polymer fasteners
- With adjustable buckles

- B-7017-XS** - Junior X-Small (16"-20")
- B-7017** - Junior Small (20"-24")
- B-7018** - Junior Medium (24"-28")
- B-7019** - Senior Small (26"-30")
- B-7020** - Senior Medium (30"-34")
- B-7021** - Senior Large (34"-38")
- B-7022** - Senior Large (38"-42")



**SUSPENDERS**

- Adjustable
- Functional & long lasting
- Sturdy rubber hooks

- B-7027** - Junior One size
- B-7028** - Senior One size



# COACH



# & REFEREE

**HOCKEY DELUXE CLIPBOARD**



- Recto: Full ice
- Verso: Half-ice
- Dry erase pen included

**BL-HDC** - 10" x 16" (25,4cm x 40,64cm)



**HOCKEY COACHBOARD - SUCTION CUPS**

- Full ice
- With handle
- Dry erase pen included

**BL-BMS016** - 16" x 24" (40,64cm x 60,96cm)



**HOCKEY COACHBOARD - RIGID**

- Full ice
- Three(3) smaller full ice
- Dry erase pen included

**BL-RBL** - 32" x 44" (81,28cm x 111,76cm)



**HOCKEY COACHBOARD - GOALIE**

- Recto: Half-ice + two(2) goalie crease
- Verso: Four(4) Half-ice + four(4) goalie crease
- Dry erase pen included

**BL-GCP** - 10" x 16" (25,4cm x 40,64cm)



**HOCKEY COACHBOARD - POCKET SIZE**

- Recto: Full ice
- Verso: Half-ice
- Dry erase pen not included

**BL-PHB** - 6" x 4" (15,24cm x 10,16cm)



**HOCKEY COACHBOARD - SELF-ADHESIVE**

- Four(4) Full ice
- Replaceable
- Self-adhesive film

**BL-SAB** - 25" x 17" (63,5cm x 43,18cm)



**DRY ERASE PEN**

- BL-PEN-BLACK** - Black
- BL-PEN-BLUE** - Blue
- BL-PEN-GREEN** - Green
- BL-PEN-RED** - Red



**TWO-WAY FOLDER - HOCKEY**

- Recto: Full ice
- Verso: Half-ice
- Pocket size board included
- Dry erase pen included

**BL-2WF** - 11" x 15" (27,94cm x 38,10cm)



**OUTDOOR TACTICAL BOARD**

- Recto: Full field
- Verso: Half-field
- Dry erase pen included

**BL-BDC** - Baseball - 10" x 16"

**BL-LACROSSE** - Lacrosse - 10" x 16"



**PLAYMAKER LCD 14"**



- Better contrast
- Lineup card on the back
- Better battery life
- Lock function

- BL-PM405-HOCKEY
- BL-PM410-SOCCER
- BL-PM420-BASKET
- BL-PM450-STYLUS
- BL-PM000-POP - Pop display
- BL-PM010-POP - Pop display

DIGITAL BOARD

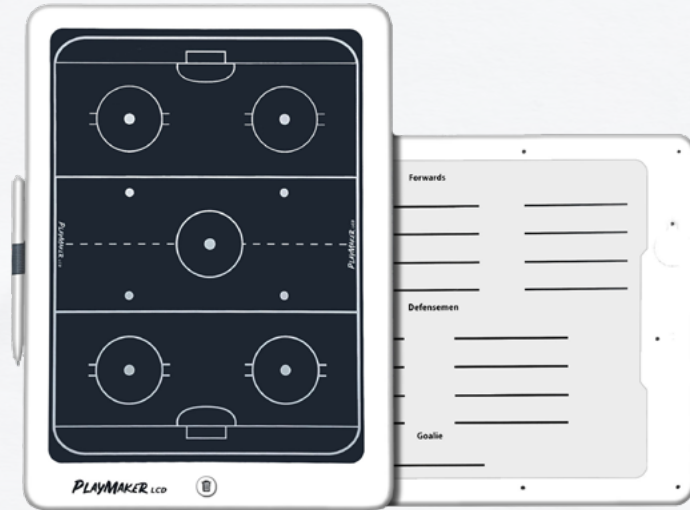

**PLAYMAKER LCD 20"**



- Two(2) suction cups
- Two(2) CR2430 batteries included

- BL-PM500-HOCKEY
- BL-PM510-SOCCER
- BL-PM520-BASKET



**PROTECTIVE SLEEVE**



- Felt construction
- Zipper fastener
- Waterproof lining

- BL-PM440-SLEEVE - 14"



**CARRYING CASE**



- Felt construction
- Zipper fastener
- Waterproof lining

- BL-PM540-carry - 20"



**PLAN2PLAY COACHING BOARD**



- Multiple pages to plan lines, drills and write notes
- Save precious time and paper

- BL-P2P-HOCKEY
- BL-P2P-SOCCER
- BL-P2P-BASEBALL
- BL-P2P-PENBLACK - Sold separately
- BL-P2P-PENRED - Sold separately



DRY-ERASE



**WHISTLE - BLUE 01**

- High impact symonite
- Deep tone
- Squared mouth piece
- Lanyard included



**BL-WP-01** - Large

**WHISTLE - BLUE 09**



- Nickel plated brass
- Medium tone
- Tapered mouth piece
- Adjustable finger grip



**BL-WP-09** - Large

**ACME THUNDERER 246-585**

- Nickel plated brass
- Medium tone
- Tapered mouth piece
- Velcro strap glove grip



**BL-W246-585** - Large

**ELECTRONIC WHISTLE**

- Three(3) tones
- Lanyard included
- 120 Decibels



**BL-WP-E** - One size

**SPORT STOPWATCH**

- Clock, calendar & lighted display
- Unlimited splits
- Shock resistant
- One(1) lap timer



**BL-EC4413**

**ACME THUNDERER 477-585**

- Nickel plated brass
- Medium tone
- Tapered mouth piece
- Adjustable finger grip



**BL-W477-585** - Brass

**BL-W477-585-BLACK** - Matte Black

**TALL BOY STRAW CAP**

- 1000 ml
- With straw



**ITBBK** - Black

**ITBB** - Blue

**BLUE SPORTS BOTTLES**

- 850 ml
- Clear strip to see fill level
- Fits most bag pockets



**BL-BFORCE-AUTO**

**BL-BFORCE-STRAW** - With straw

**FOLDABLE BOTTLES CARRIER**

- Can hold six(6) bottles
- Foldable
- Bottles not included



**BL-PBC6L** - Black

TRAINING



ON/OFF ICE

**TRIANGULAR PASSER**

- Improve you passing skills
- Anchoring system for ice
- Puck not included



**BL-TPA3** - Passer  
**BL-EBR** - Replacement band

**SKILLMASTER**

- Limitless configuration with five(5) branches
- Total lenght: 66.5 inches
- Full thickness high density plastic



**BL-SKILLMASTER**

**BALANCE BOARD**

- Improve your strenght & coordination
- High quality wooden board
- Maximum load of 136 kg
- Improve your stability



**BL-BALANCE-B**

**MINI BANDS  
 MINI BANDES**

**NEW**

- Made of superior latex material
- Ideal for upper and lower body training
- Designed to avoid pinching the skin



**BL-MINI-BANDS**

**AGILITY LADDER**

**NEW**

- Tangle-free fold
- Improve acceleration
- Enhances balance



**BL-QUICK-LADDER**

**JUMP ROPE - HIGH PERFORMANCE**

- Handles designed to maximize rope rotations
- Add speed to conditioning training

**NEW**



**BL-SPEED-ROPE**

**CONE - 6"**



- Weighted
- High-visibility color
- Made of soft PVC



**BL-C7E** - Orange

**TRIANGULAR CONE - 7"**

- High-visibility color
- Made of sturdy TPR



**BL-CTCT-7** - Orange

**SAUCER KIT - 50**

- Carrier included
- Yellow x25
- Orange x25



**BL-CMC-10** - Kit

**RINGUETTE PRACTICE RING**

- Made of sponge rubber
- Diameter: 6.75 inches



**BL-DTR** - Blue

**ATTACK TRIANGLE**

- Replicate the skates & stick of an opponent
- Provides a realistic obstacle
- Develop slick stick moves



**BL-ATTACK**

**STICK HANDLING TRAINER**

- Movable posts
- Anchoring system for ice
- Total length: 47 inches



**BL-HA4**

**SLIDING BOARD**

- Six(6) foot length x 22" wide
- Rollable with strap
- Two(2) speed booties included



**B-SLIDE-ADJ** - Junior

**SLIDE-SOAKERS** - Replacement soakers

**RECTANGULAR PASSER**

- Improve your passing skills
- Puck not included
- Anchoring system for ice



**BL-RPA4** - Passer

**BL-EBRRP** - Band

**SPEED CHUTE**

**NEW**

- Progressive resistance
- Quick-release buckle
- Maximize acceleration



**BL-SPEED-CHUTE**

**SPEED HURDLES**

**NEW**

- Bounce-back construction
- Lightweight & durable
- Increase speed & agility



**BL-SPEED-HURDLES**

**SPEED RADAR**

- Adjustable angle
- Aluminium tripod
- Adjustable height from 14" to 28"



**BL-SPEED** - Radar

**BL-STAND** - Tripod (sold separately)

**TRAINING SURFACE**

- Easily attach together
- Highly resistant



**KITTUILE20** - Box of 20 tiles

**KITTUILE10-BLUE** - Box of 10 tiles

**KITTUILE10-RED** - Box of 10 tiles

**KITTUILE-CORNER** - Corners for tiles

**KITTUILE-EDGE-S** - Edge for tiles «straight»

**KITTUILE-EDGE-H** - Edge for tiles «hooks»



# PUCKS



# \$ BALLS

**GREEN BISCUIT**

- Off-ice stickhandling practice
- Pack of 12 pucks
- Weight: 4.8 oz/puck
- **Cannot be shot**



**GB-P10** - Green

**GREEN BISCUIT - SNIPE**

- Wrist shots practice
- Slapshots practice
- Pack of 12 pucks
- Weight: 5.2 oz/puck



**GB-SNIPE** - Green

**GREEN BISCUIT - PRO**

- Makes the saucer pass an easy skill to master
- Pack of 12 pucks
- Weight: 4.8 oz/puck
- **Cannot be shot**



**GB-PRO** - Green

**GREEN BISCUIT - ROLLERBLADE**

- Off-ice stickhandling practice
- Pack of 12 pucks
- Weight: 3.6 oz/puck



**GB-ROLLERHOCKEY** - Black

**GREEN BISCUIT - COMBO**

- Include one(1) OG & one(1) snipe
- Six(6) packs of two(2) pucks



**GB-COMBO** - Green

**GREEN BISCUIT - FLAGS**

- Off-ice stickhandling practice
- Pack of 12 pucks
- Weight: 4.8 oz/puck
- **Cannot be shot**



**GB-USA** - USA

**PUCK - TRUE FEEL**

- Truefeel of a puck on ice surface
- Ideal for simulated ice surfaces
- Can be shot like a real puck



**BL-TRUEFEEL**

**PUCK - SPONGE**

- Lets you practice wherever you like
- Safer for indoor play
- Reduces muscle strain as you practice



**ISPONGE** - Black

**BALL - HOCKEY**

- Low bounce
- Off-ice stickhandling practice
- Perfect for league or street game



**BL-531** - Pink - Cold weather

**BL-541** - Orange - Low bounce

**BL-551** - Orange - Low bounce - Indoor

**BALL - SWEDISH STICKHANDLING**

- Diameter: 2 inches
- Made of hard wood
- Help develop quick hands



**BL-SWB-2** - Wood

**BALL - REACTION & FLOORBALL**

- Diameter: 3.5 inches (3 in. floor)
- Six(6) bumps version
- Dense rubber for durability

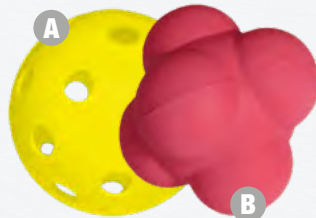

**A** **BL-FLB-W** - White

**BL-FLB-RED** - Red

**BL-FLB-YEL** - Yellow

**B** **BL-RB10** - Box of six(6)

**FOAM BALLE**

- Made of soft foam
- Great for mini-hockey
- Box of 24 balls



**BL-MINIB-24** - Blue

MULTIPLE



ACCESSORIES

# STICK WAX & GRIPS

Our hockey stick wax give you better puck control, prolong your tape job and avoid water and snow accumulation. Applying wax before each game also keep your stick wiping clean.

## HOCKEY STICK WAX

- Weight: 2oz
- Prevent snow build-up
- Better puck control

<b>BL-TINWAX-CLEAR</b> - Unscented	○
<b>BL-TINWAX-BLACK</b> - Unscented	●
<b>BL-TINWAX-BLUE</b> - Sea salt & sage	●
<b>BL-TINWAX-RED</b> - Strawberry	●
<b>BL-TINWAX-YELLOW</b> - Lemon	●
<b>BL-TINWAX-ORANGE</b> - Coconut & mango	●
<b>BL-TINWAX-GREEN</b> - Green apple	●
<b>BL-TINWAX-PINK</b> - Bubblegum	●



SMELLS GREAT  
→



## SPRAY GRIP

- Great for all sports
- Durable
- Spray bottle of 100 ml



905525

# EQUIPMENT MANAGER MUST-HAVE

The hockey equipment manager collects information from their team and orders the equipment that is necessary for them to play. They manage virtually everything related to the team's equipment inventory. If a player requires specific equipment to perform, the equipment manager accommodates their needs and BLUE SPORTS is there for them.

## ANTI-FOG

- Works on every type of lens or visors
- Glasses
- Spray bottle of 150 ml

905505 - Pack of 12



## SHARP STYCK

- Helps when blades become dull
- Manual tool
- Display box of 12 units

BL-SHARP STYCK - Pack of 12



## INSTANT COLD COMPRESS

- For pain relief and swelling
- Single use
- Display box of 12 packs

BL-COLD



## FIRST AID KIT

- Contains more than 20 pieces

B-FAK - Red



## TAPE SCISSORS

- Saw blade
- Ensure a clean and easy cut of the tape
- Ergonomic handle

BL-SCISSORS - Black & blue



## TAPE TIGER

- Tiger tooth design protects fingers from blade
- Removable hardened steel cutting blade
- Scissors for a clean, professional finish

BL-OTGT - Black  
BL-RPBTGT - Blades (3)



## SKATE BLADE POUCH

- Store and protect your extra set of blade
- Interior divider
- Tough material

BL-SBPOUCH - Black  
BL-SBPOUCH-4 - Black



## MULTI WIPE

- Quick dry microfiber towel
- 100% Polyester
- Machine or hand washable

BL-MULTIWIPE - Blue



**GEL PAD - LACE BITE**

- Includes one(1) pair
- Disperse pressure

905507 - One size (senior)



**GEL PAD - ANKLE**

- Includes two(2) pairs
- Disperse pressure

905509 - One size (senior)



**GEL PAD - ACHILLES TENDONS**

- Includes one(1) pair
- Disperse pressure

905508 - One size (senior)



**LACE BITE PROTECTOR SLEEVE**

- Includes one(1) pair
- Soft polyester sleeve with PU gel
- Disperse pressure

905515 - One size (senior)



**WOOD END PLUG**

- Pre-glued insert section for easy installment
- Extend length of stick

BL-WEP-JR-8 - Junior 8"

BL-WEP-JR-12 - Junior 12"

BL-WEP-INT-9 - Intermédiaire 9"

BL-WEP-SR-8 - Senior 8"

BL-WEP-SR-12 - Senior 12"



**COMPOSITE END PLUG - ADJUSTABLE**

- From 0.5" to 4"
- Made of composite material
- Lightweight, robust & easy to adjust

PR-ADJ-JR - Junior

PR-ADJ-INT - Intermédiaire

PR-ADJ-SR - Senior



**LAUNDRY STRAP**

- Improve cleaning & sanitation
- Dries clothes in half time

BL-LAUNDRY - White

BL-LAUNDRY-BLK - Black

BL-LAUNDRY-NAV - Navy

BL-LAUNDRY-RED - Red

BL-LAUNDRY-YEL - Yellow



**LAUNDRY BAG - DELUXE**

- Nylon mesh, washing machine & dryer safe
- Velcro strap closure
- Size: 18" x 28"

BL-WASHBAG - Black



**MOUTHGUARD - STRAPLESS**  
PROTECTEUR BUCCAL SANS ATTACHES



- Étui de rangement inclus
- / Storage case included

MG8001JR-BK - Black/Noir

MG8001JR-CLEAR - Clear/Transparent

MG8001JR-BLU - Blue/Bleu

MG8001JR-GRE - Green/Vert

MG8001JR-OR - Orange

MG8001JR-RED - Red/Rouge

MG8001JR-YEL - Yellow/Jaune

MG8000SR-BK - Black/Noir

MG8000SR-CLEAR - Clear/Transparent

MG8000SR-BLU - Blue/Bleu

MG8000SR-GRE - Green/Vert

MG8000SR-OR - Orange

MG8000SR-RED - Red/Rouge

MG8000SR-YEL - Yellow/Jaune

**ACCESSORY BAG**  
SAC D'ACCESSOIRES

NEW / NOUVEAU

- Size: 14" x 12.5" x 12"
- / Grandeur: 38cm x 31,5cm x 30cm
- Divisions inside
- / Divisions à l'intérieur
- Durable fabric with heavy-duty zippers
- / Matériau résistant avec glissières robustes

BL-TOILETRY - Blue Sports

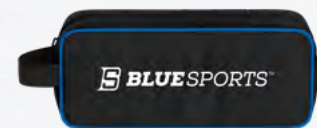

# GOALIE ACCESSORIES

In addition to the main equipment, most goalies choose to wear a variety of accessories to both enhance the level of protection or assist in the comfort of their gear.

## SILICONE PROTECTOR

- Protects against stains & puck marks
- Revitalize surface after cleaning
- Improves glide of goalie pads



**BL-GUARD** - 12 units of 14oz

## PUCK OUT

- Removes puck marks
- Easy to use
- Two(2) puck erasers included



**PUCK OUT** - 4oz/118ml

## OPEN GOAL MASK HARNESS

- Five(5) points harness
- Let the rear skull plates opened
- Easy to install



**BL-OGH5PT-WH** - White  
**BL-OGH5PT-BK** - Black  
**BL-OGH5PT-BL** - Blue  
**BL-OGH5PT-RD** - Red

## GOAL PADS HOOK SYSTEM

- Three(3) pieces
- Suitable for both(2) goalie styles
- Revolutionary system



**BL-TOEHOOK3** - System  
**BL-RPTOEHOOK3** - Parts

## GOAL MASK HARNESS

- Elastic harness straps
- Five(5) harness strap clips
- Adjustable



**BL-GH5PT-BK** - Black  
**BL-GH5PT** - Natural

## GOALIE MASK SWEATBANDS

- Two(2) soft terry cloth bands
- Fits all mask
- Easily removable & Washable



**BL-SWTB-BK** - Black  
**BL-SWTB-WH** - White

## THROAT GUARD - V-STYLE

- Made of Lexan
- Fits all mask
- Improves freedom of movement



**BL-LTG-V-JR** - Junior  
**BL-LTG-V-SR** - Senior

## X-TRACKER VISUAL TRAINING

- Helps you correct your stance
- Enhance your posture
- Improve how you track the puck



**XTRACKER** - One size

## GUARDIAN ANCHORPEGS

- Stays in place without sacrificing safety
- Absorbs goaltenders impact



**GA001** - North America  
**GR001** - Adjustable

## GOALIE PADDED INNER GLOVE

- Thin construction
- Velcro closure on the inside of the wrist
- Leather palm



**BL-GPGLOVE-JR-S**  
**BL-GPGLOVE-JR-M**  
**BL-GPGLOVE-JR-L**  
**BL-GPGLOVE-JR-XL**  
**BL-GPGLOVE-SR-S**  
**BL-GPGLOVE-SR-M**  
**BL-GPGLOVE-SR-L**  
**BL-GPGLOVE-SR-XL**  
**BL-GPGLOVE-SR-XXL**

# MISCELLANEOUS

## TALLY COUNTER

- Four(4) figures
- Easy push button actuator
- Instant reset knob



**BL-UIC1100** - Chrome

## LACE TIGHTENER

- High-quality materials
- Easy to use
- Beveled edge prevents tearing of lace



**BL-SLT-CROCHET** - Black

## SKATE BAG - DELUXE

- Durable fabric with heavy-duty zippers
- Adjustable shoulder strap
- Side mounted pocket



**BL-BSHSB** - Black

**BL-BLSHB** - Blue

**BL-PIHSB** - Pink

## HELMET BAG - FLEECE

- Made with soft fleece material
- Fits goalie mask or player helmet
- Protect against impacts & scratches



**BL-GPMBAG** - Black

## EXPANDABLE SHIN PAD TUBES

- Holds shin pads in place
- Keep the leg warmer
- Comfortable



**B-7201** - Small-Medium

**B-7202** - Large-Xlarge

## SANDALS - SHOWER

- Slip-resistant & quick-dry
- Thick soles



**BL-SC45** - US 4-5/EU 37-38

**BL-SC67** - US 6-7/EU 39-40

**BL-SC89** - US 8-9/EU 41-42

**BL-SC1011** - US 10-11/EU 43-44

**BL-SC1213** - US 12-13/EU 45-46

## REPLACEMENT FOAM

- Peel & stick
- 1X 4" x 6" x 3/8"
- 1X 4" x 6" x 1/4"



**BL-RFP-L** - Pack of two(2)

## ADJUSTABLE SKATES

- Double blades provide superior balance
- Quick release strap
- Adjustable for youth size 13-6



**BOBSKATE-NOIR** - Black

**BOBSKATE-ROSE** - Pink

## ICE MARKER

- Perfect for on-ice training sessions
- Specially formulated for ice
- 16oz spray can



**BL-MARK-BLUE** - Blue

**BL-MARK-RED** - Red

## PLASTIC BLADE

- Perfect for off-ice training sessions



**BL-PJTC-01** - Black



# SHARPENING



# & REPAIRS

**HONE STONE - TEAR DROP**

- Size: 2-1/2" x 1" (small) - 4-1/2" x 1-3/4" (large)  
- Grit: 320

**DUC-4004-S** - Small  
**DUC-4004-L** - Large

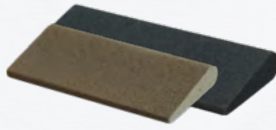

**HONE STONE**

- Size: 4-1/2" x 1/4"

**BL-HONEPINK** - Pink (320 grit)  
**BL-HONEBLK** - For black steel

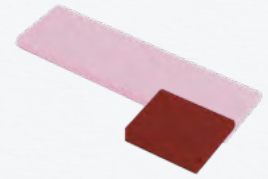

**RECTANGULAR STONE & POUCH**

- 3" long  
- Includes carrying pouch

**JP-10**

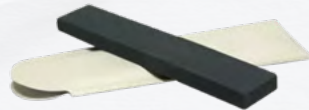

**DIAMOND DRESSER - STANDARD**

- 0.15 carat  
- Fits Blademaster, Blackstone & Fleming Gray

**DUC-687**



**HELMET HARDWARE KIT**

- Complete replacement

**BL-PHHK** - Player  
**BL-GHHK** - Goalie



**REPAIR PARTS - HEEL TENDON**

- Fits on any skates size 5 and up

**BL-HTR**

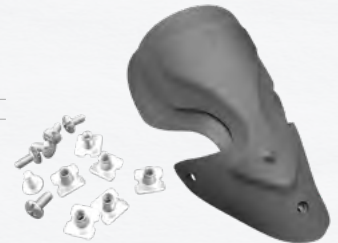

**TUBULAR STEEL RIVETS - BLACK**

- Sizes: 7/16 - 8/16 - 9/16 - 10/16 - 11/16

**BL-RIV** - Pack of 250



**COPPER RIVETS & WASHERS**

- Size: 1-1/4"  
- Sold separately

**20CR** - Pack of 100  
**20CW** - Pack of 100



**HELMET HARDWARE - 50 PIECES PER PACK**

- All the necessary pieces to repair your helmet  
- Everything is sold separately & per pack of 50 units

- A** **BL-XEARLOOP** - Ear strap (pair)
- B** **BL-XLONGNUT** - Long nut
- C** **BL-XG-STEELCLIP** - Metal goalie mask clip
- D** **BL-XLOOP** - Nylon eyelet with pressure fastening bolt
- E** **BL-XCHINSTRAP** - Chin strap eyelet with plastic snap fastener
- F** **BL-XBIGBUCKLE** - Large plastic snap clip for goalie mask
- G** **BL-XJCLIP** - Plastic "J" shaped stopper clip for face shield (pair)
- H** **BL-XSNAPBOLT** - Pressure fastening bolt
- I** **BL-XFLATBUCKLE** - Plastic snap clip for face protector strap
- J** **BL-XTOPCLIP** - Plastic clip for face shield
- K** **BL-XSHORTNUT** - short nut
- L** **BL-XLONGBOLT** - Long screw
- M** **BL-XSHORTBOLT** - Short screw



**BLUESPORTS™**

# FLAGSHIP PRODUCTS



# DISTRIBUTION CENTERS

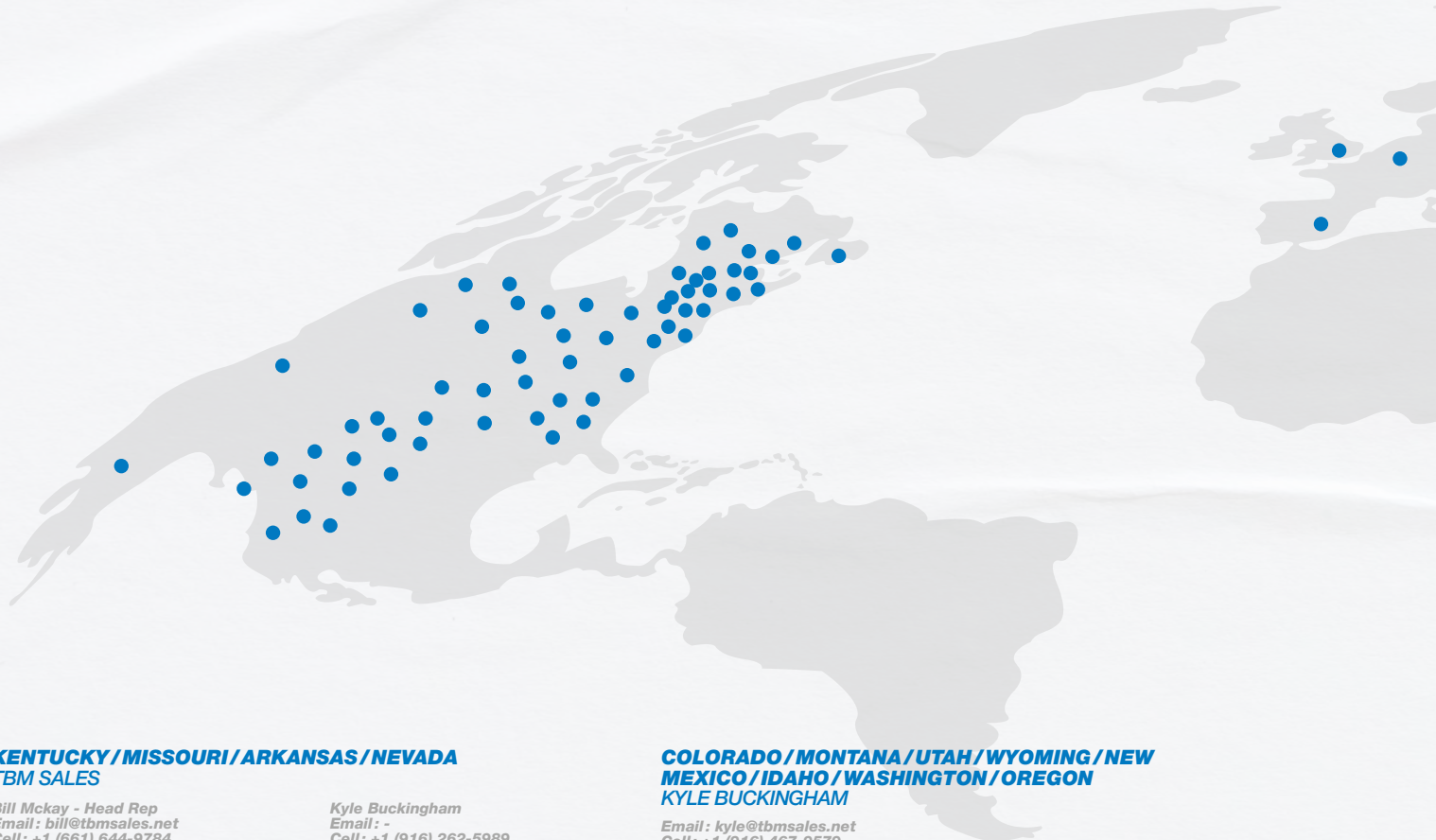

**KENTUCKY / MISSOURI / ARKANSAS / NEVADA**  
TBM SALES

Bill Mckay - Head Rep  
Email: bill@tbmsales.net  
Cell: +1 (661) 644-9784

Kyle Buckingham  
Email: -  
Cell: +1 (916) 262-5989

Liz Mckay  
Email: liz@tbmsales.net  
Phone: +1 (813) 982-9090

Brad Mayer  
Email: -  
Phone: +1 (941) 351-8405

Kevin Wu  
Email: kevin@tbmsales.net  
Cell: +1 (858) 761-1437

Mark Ladwig  
Email: -  
Phone: +1 (302) 377-9664

**CALIFORNIA / ARIZONA / ALASKA / HAWAII**  
KEVIN WU

Email: kevin@tbmsales.net  
Cell: +1 (858) 761-1437

**FLORIDA / ALABAMA / MISSISSIPPI / LOUISIANA / GEORGIA**  
MARK LADWIG

Email: fargomcservices@gmail.com  
Cell: +1 (302) 377-9664

**TEXAS / OKLAHOMA**  
BRAD MAYER

Email: brad@smarthockey.com  
Cell: +1 (941) 351-8405

**COLORADO / MONTANA / UTAH / WYOMING / NEW MEXICO / IDAHO / WASHINGTON / OREGON**  
KYLE BUCKINGHAM

Email: kyle@tbmsales.net  
Cell: +1 (916) 467-9579

**MINNESOTA / NORTH & SOUTH DAKOTA / WISCONSIN / IOWA / NEBRASKA / KANSAS**  
ANDY TUCKER

Email: andytucker10@gmail.com  
Cell: +1 (952) 210-0500

**MASSACHUSETTS / CONNECTICUT / RHODE ISLAND / NEW HAMPSHIRE / MAINE / VERMONT**  
TIM GENTILE

Email: tgentile02@gmail.com  
Cell: +1 (207) 703-8268

**MICHIGAN / OHIO / INDIANA / ILLINOIS**  
STEVE RYMSHA - ANDY RYMSHA (MAJOR ACCOUNTS)

Email: steve.rymsha@warrior.com  
Cell: +1 (248) 914-0160

Email: andy.rymsha@warrior.com  
Cell: +1 (248) 798-9810

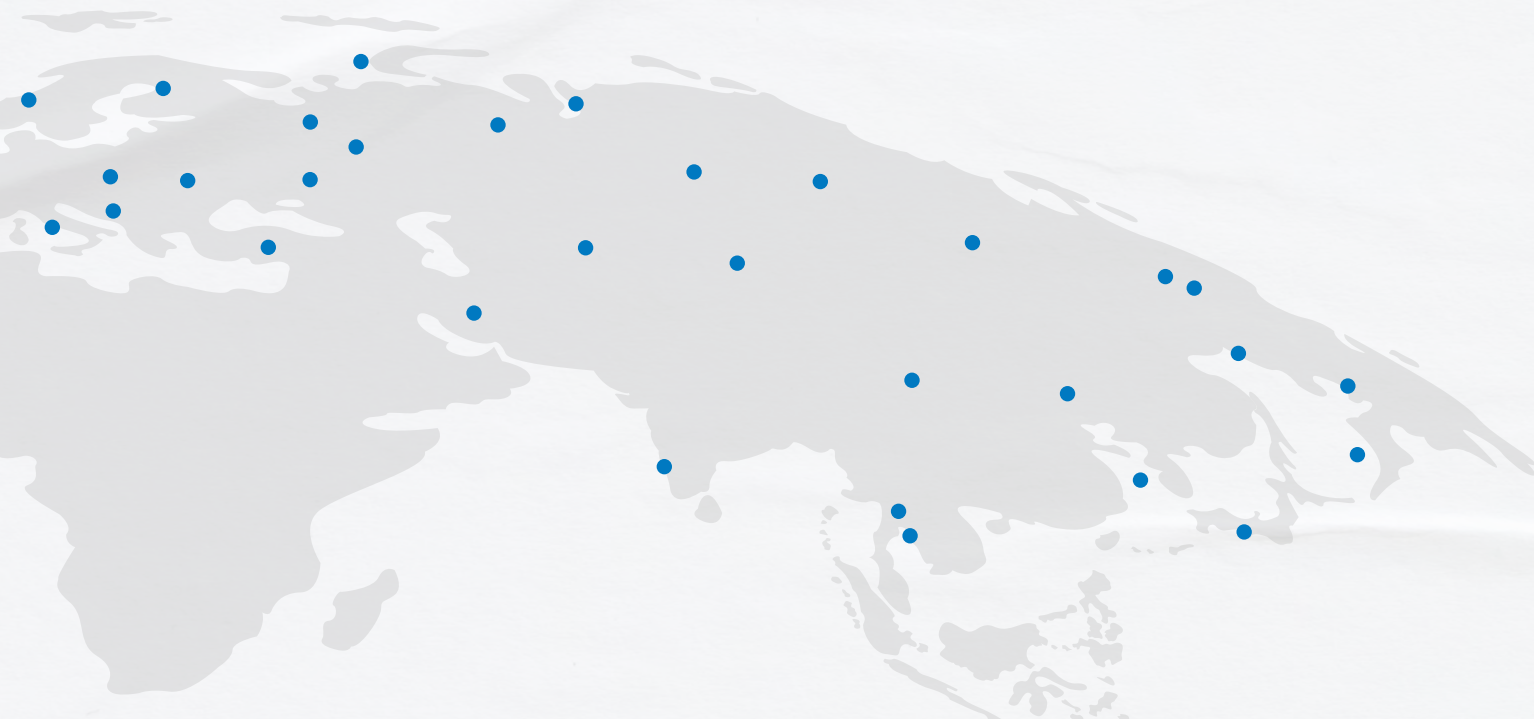

**NY/LONG ISLAND/NEW JERSEY/PENNSYLVANIA/DELAWARE/MARYLAND/VIRGINIA/WEST VIRGINIA/NORT & SOUTH CAROLINA/TENNESSEE**  
**STEVE RONCA**

Email: srulcsales@aol.com  
 Cell: +1 (484) 942-7885

**MONTREAL/NORTH & SOUTH-SHORE/OUTAOUAIS**  
**JEAN-FRANÇOIS TAUPIER - AGENCE SPORTIVE TAG**

Email: jftaupier@agencetag.ca  
 Cell: +1 (514) 984-7400

**EASTERN QUEBEC**  
**MICHEL CIARLO - AGENCE 2MJ**

Email: michelciarlo@hotmail.com  
 Cell: +1 (418) 953-1335

**BRITISH COLUMBIA**  
**JEAN-FELIX PROULX**

Email: jf@blue-sports.com  
 Cell: +1 (819) 698-8843

**ATLANTIC/MARITIMES**  
**GREG A. PETTIS - GAP SALES AGENCY**

Email: gap@accesscable.net  
 Cell: +1 (902) 497-5720

**ONTARIO**  
**JEFF SARGINSON - JGS SPORTSWEAR**

Email: jgssports@rogers.com  
 Cell: +1 (647) 981-8969

**SASKATCHEWAN/MANITOBA/ALBERTA**  
**RANDY HURD - FIREDOG HOCKEY & SPORTS**

Email: fire.dog@sasktel.net  
 Cell: +1 (306) 981-1023

**EUROPEAN SALES**  
**EVE GUILBAULT**

Email: eve@blue-sports.com  
 Cell: +1 (819) 293-9740

**N-A SALES**  
**JEAN-FELIX PROULX**

Email: jf@blue-sports.com  
 Cell: +1 (819) 698-8843





 **BLUESPORTS™**